

Marida 30



Front view 1



Front view 2

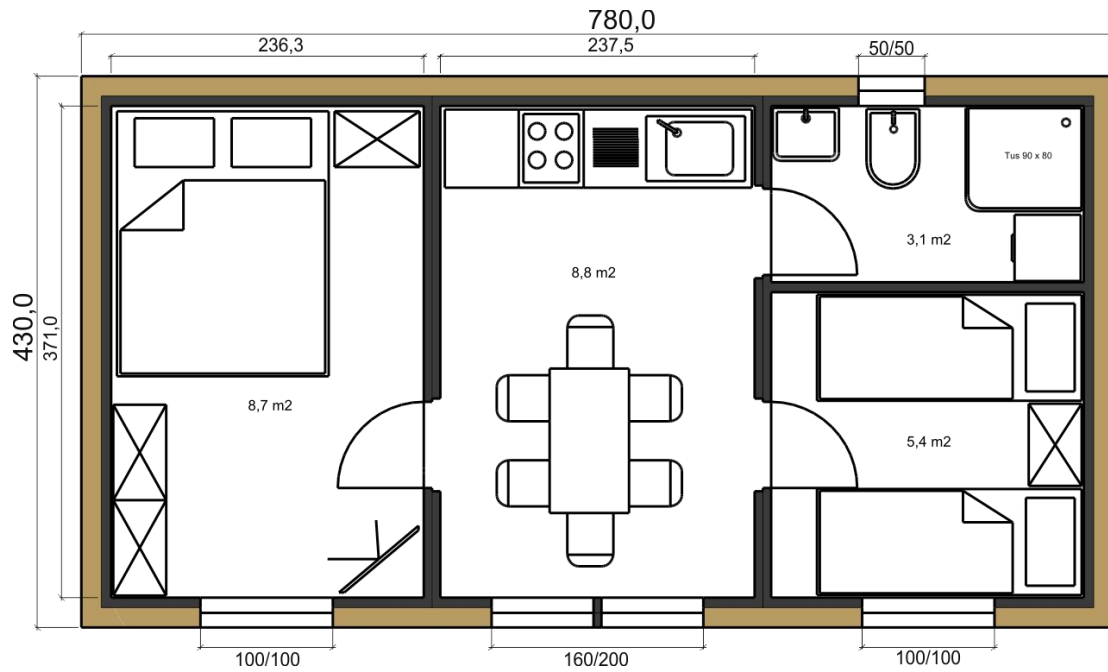

Floor plan

A1 GENERAL

Area (m2)	33,54
Sleeping capacity	4+2
Number of bedrooms	2
Number of bathrooms	1
Length (m)	7,80
Width (m)	4,30
Height (m)	3,91

B1 FLOOR

Floor metal construction	0
Insulating metal panels	0
Mineral wool insulation	0
Parapermeable foil	0
Wooden floor beams	0
Styrofoam	0
Waterproof floor covering binyl 8 mm	0

C1 EXTERNAL WALL SECTION

Knauf plate 12,50 mm painted white in finish	0
Fermacell plate 12,50 mm	0
Steam brake	0
Wooden load-bearing structure 10 cm statically and thermodynamically calculated	0
Mineral wool insulation 10 cm	0
Fermacell plate 12,50 mm	0
Facade wool 15 cm	0
Silicate facade layer in white color	0
Marble benches	0

C2 PARTITION WALL SECTION

Knauf plate 12,50 mm painted in white finish	0
Fermacell plate 12,50 mm	0
Wooden load-bearing structure 10 cm statically and thermodynamically calculated	0
Mineral wool insulation 10 cm	0
Fermacell plate 12,50 mm	0
Knauf plate 12,50 mm painted in white finish	0

C3 WINDOWS AND DOORS

PVC anthracite joinery	0
3 glasses	0
5 chambers	0
Mosquito nets	0
Electric blinds	0

C4 ROOF AND CEILING

Knauf plate 12,50 mm painted in white finish	O
Wooden roof grille of calculated durability for snow and wind loads	O
Mineral wool insulation	O
Vapor barrier	O
Steam barrier	O
External metal sheet white cover with 10 mm insulation	O
Gutters	O
Pipes	O
Leaves	O

D1 BATHROOM

Shower tray 80x80 cm	O
Shower cabin 80x80 cm	O
Shower mixer	O
Toilet bowl with soft close board system	O
Washbasin cabinet 50 cm	O
Sink mixer	O
Mirror 50 cm with shelf	O
El. boiler 50l external regulation	O
Bathroom flat radiator 833 W	O
Washing machine	X
Ceramic tiles	O

D2 MASTER BEDROOM

Wardrobe in white color 117x190 cm	O
Double bed 160x200 cm	O
Bed flooring	O
Mattress 160x200 cm	O
TV holder	X
TV 32 inch	X
Night stand in white color 35x49 cm	O

D3 CHILDREN ROOM

Wall hanging closet 180 cm	O
Sleeping beds 80x200 cm	O
Bed flooring	O
Mattresses 80x200 cm	O
TV holder	X
TV 32 inch	X
Night stand in white cove 35x49 cm	O

D4 KITCHEN

Kitchen lower freestanding and upper hanging elements 200 cm	O
Electric oven	O
Kitchen hood	O
Induction electric hob - 4 places	O
Freestanding refrigerator	O
Built in sink, one base with strainer, stainless steel	O
Sink faucet, effect stainless steel	O
Kitchen table 120/180 cm	O
Kitchen chairs	O

E1 WATER AND GAS

External connector to water	O
Connection to central warm water	O
Connection to central wastewater	O
PVC water pipes	O
Central wastewater outlet	O
Electrical water heater	O

E2 ELECTRICAL INSTALLATIONS

Lighting fixtures in each rooms	O
Flush mounted installations, sockets and switches	O
External electric connection	O
Outdoor terrace socket	O
Anthracite exterior lamps on the front	O
TV sockets	O
LAN socket	O

E3 HEATING AND COOLING

Air conditioner Bosch inverter, 3,5 kW	O
Bathroom radiator flat 833 W	O
Dream Heat electric ceiling heating system with associated wi-fi control thermostats	O

F1 TERRACE / EXTERIOR EQUIPMENT

Terrace dimension 7,8x3 m	X
Metal chassis	X
Terrace tiles 2x60x60 cm	X
Sheet metal white cover 30 mm insulation	X
Metal vertical and horizontal supporting terrace pillars	X
Parapet decorative cladding with anthracite sheet metal around the terrace	X
Metal stairs with terrace tiles 2x60x60 cm on the sides finished with anthracite sheet metal	X

